



# Building Hardware



# Building Hardware

## Builder's Metalwork

Masonry Hangers	230
Timber Hangers	231
Restraints	232
Wall Starter Kits	232
Truss Clip	233
Angle Bracket	233
Flat Connector Plate	233
Herringbone Joist Strut	233
Nail Plate	233
Universal Framing Anchor	233
Timber Connector	234
Helical Bar	234
Brick Reinforcement Coil	234
Fixing Band	234
Waterbar	234
Drywall Bracket	234
Cramps & Ties	235-236

## Building Supplies

Damp Proof Membrane	236
Builders Tape	236
Spacers	237
Roof-line & Above	239
Weeps & Drill Vents	239
Underfloor Ventilation	240
Through-Wall Ventilation	240
Internal Grille Vents	241
Loft Doors & Access Panels	241

## Refuse

Builders Bulk Bags	242
Sandbags	242
Rubble Sacks	242

# Masonry & Multi-Functional Hangers



## Single Piece Masonry Hanger



Straight top flange. No welds. Hangers above 150mm are manufactured 10mm less to allow for notching and regularised timber.



APPROVED

## Welded Masonry Hanger



Hangers above 150mm are manufactured 10mm less to allow for notching and regularised timber.



## Multi-Functional Hanger



Designed for use with different fixings to give greater flexibility and improved performance.

NOTE: Total length refers to the length of the hanger when flat.

Technical Data	
Width (mm)	47
Height (mm)	100   125   140   165   190   215
Bearing (mm)	80   75
No. of Nail Holes	6
Characteristic value (kN)*	9.7
Safe working load (kN)#	5.4

\*Eurocode 6 | #BSS628

Technical Data					
Width (mm)	47	75	90	100	150
Height (mm)	All				
Bearing (mm)	80		75   90		
No. of Nail Holes	6				
Characteristic value (kN)*	6.7				
Safe working load (kN)#	3.5				

\*Eurocode 6 | #BSS628

Technical Data				
Total Length (mm)	240	346	404	504
Width (mm)	47	All		
Bearing (mm)	85			
Characteristic value (kN)*	N/A	12.8	19.8	25.1
SWL (kN)# - Short term	N/A	6.4	9.9	12.55
SWL (kN)# - Medium term	N/A	6.1	9.4	11.95
SWL (kN)# - Long term	N/A	5.3	8.25	10.45

\*Eurocode 6 | #BSS628 SWL-Safe Working Load

Product Code	W x H x B (mm)	Joist W x H (mm)	MOQ Qty (pcs)	Qty Break (pcs)
<b>BOX</b>				
<b>Galvanised Steel - 2.4mm</b>				
47100MH	47 x 100 x 80	47 x 100	10	50
47125MH	47 x 125 x 80	47 x 125	10	50
47147MH	47 x 140 x 80	47 x 150	10	50
47175MH	47 x 165 x 75	47 x 175	10	5
47200MH	47 x 190 x 75	47 x 200	10	50
47225MH	47 x 215 x 75	47 x 225	10	50

BMW01

Product Code	W x H x B (mm)	Joist W x H (mm)	MOQ Qty (pcs)	Qty Break (pcs)
<b>BOX</b>				
<b>Galvanised Steel - 2.4mm</b>				
75150WMH	75 x 140 x 80	75 x 150	10	50
75175WMH	75 x 165 x 80	75 x 175	10	50
75200WMH	75 x 190 x 80	75 x 200	10	50
75225WMH	75 x 215 x 80	75 x 225	10	50
90150WMH	90 x 140 x 80	90 x 150	6	30
90175WMH	90 x 165 x 80	90 x 175	6	30
90200WMH	90 x 190 x 80	90 x 200	6	30
90225WMH	90 x 215 x 80	90 x 225	6	30
100150WMH	100 x 140 x 75	100 x 150	6	30
100175WMH	100 x 165 x 75	100 x 175	6	30
100200WMH	100 x 190 x 75	100 x 200	6	30
100225WMH	100 x 215 x 75	100 x 225	6	30
150200WMH	150 x 190 x 90	150 x 200	6	30
150225WMH	150 x 215 x 90	150 x 225	6	30

BMW01

<b>A2 - 304 Stainless Steel - 2.4mm</b>				
47100WMHS	47 x 100 x 80	47 x 100	6	30
47150WMHS	47 x 140 x 80	47 x 150	6	30
47175WMHS	47 x 165 x 80	47 x 175	6	30
47200WMHS	47 x 190 x 80	47 x 200	6	30
47225WMHS	47 x 215 x 80	47 x 225	6	30
100150WMHS	100 x 140 x 80	100 x 150	6	30
100175WMHS	100 x 165 x 80	100 x 175	6	30
100200WMHS	100 x 190 x 80	100 x 200	6	30
100225WMHS	100 x 215 x 80	100 x 225	6	30

BMW01

Product Code	W x H x B (mm)	Total Length (mm)	No. of Nail Holes	MOQ Qty (pcs)	Qty Break (pcs)
<b>BOX</b>					
<b>Galvanised Steel - 2.0mm</b>					
47346MFH	47 x 150 x 85	346	25	10	50
47404MFH	47 x 179 x 85	404	33	10	50
47504MFH	47 x 229 x 85	504	49	10	50
76346MFH	76 x 135 x 85	346	49	10	50
76404MFH	76 x 164 x 85	404	25	10	50
76504MFH	76 x 214 x 85	504	33	10	50
90504MFH	90 x 207 x 85	504	49	10	50
100346MFH	100 x 123 x 85	346	25	10	50
100404MFH	100 x 152 x 85	404	33	10	50
100504MFH	100 x 202 x 85	504	49	10	50
150404MFH	150 x 127 x 85	404	33	10	50
150504MFH	150 x 177 x 85	504	49	10	50

<b>Mini Multi-Functional Hanger</b>					
<b>Galvanised Steel - 1.6mm</b>					
47240MMFH	47 x 97 x 85	240	18	10	5

BMW02

### Installation Guidelines

- Ensure the back plate of the hanger sits flat against the wall and is securely fixed.
- A minimum of three block courses (675mm) must be constructed above the hanger before the joist is loaded.
- Nail the side flanges with 3.75 x 30 galvanised square twist nails.
- Allow enough time for the mortar to cure before any load is applied.

- Maximum gap between the wall and joist is 6mm.
- Joist should be square cut and sit tight to the back of the hanger.
- Hangers 150mm and above are manufactured 10mm less to allow for notching and regularised timber.

### Installation Guidelines

- All holes should be nailed using 3.75 x 30 square twist nails or equivalent.

# Timber Hangers



## No Tag Timber Hanger



Superior design allows the use of fewer nails for faster installation. Increased leg lengths, all widths can take up to a 220mm deep joist.

**Rapid Installation Time**

## Standard Timber Hanger



Designed to give a quick and simple solution for various timber connections such as joists and stairwell trimmings. Increased leg lengths, all widths can take up to a 225mm deep joist.

## Long Leg Timber Hanger



Specifically designed for deeper timber to timber applications. Ideal for loft conversions and "under-slung" floor joist applications where the hanger extends below the supporting beam. Increased leg lengths, all widths can take up to a 250mm deep joist.

Technical Data	
Width (mm)	All
Length (mm)	All
Bearing (mm)	60
Characteristic value (kN) Eurocode 5	14.41
No. of nail holes	23
Safe working load (kN) BS5628 - Short term	7.21
Safe working load (kN) BS5628 - Medium term	6.86
Safe working load (kN) BS5628 - Long term	6.0

Product Code	W x L x B (mm)	Joist W x H (mm)	MOQ Qty (pcs)	Qty Break (pcs)
<b>BOX</b>				
<b>Galvanised Steel - 0.8mm</b>				
44TH	44 x 281 x 60	44 x 125 to 220	20	100
47TH	47 x 279 x 60	47 x 125 to 220	20	100
63TH	63 x 271 x 60	63 x 125 to 220	20	100
75TH	75 x 265 x 60	75 x 125 to 220	20	100
90TH	90 x 258 x 60	90 x 125 to 220	20	100
100TH	100 x 253 x 60	100 x 125 to 220	10	50

BMW03

Technical Data	
Width (mm)	All
Length (mm)	All
Bearing (mm)	50
Characteristic value (kN) Eurocode 5	15.44
No. of nail holes	32
Safe working load (kN) BS5628 - Short term	7.72
Safe working load (kN) BS5628 - Medium term	7.35
Safe working load (kN) BS5628 - Long term	6.43

Product Code	W x L x B (mm)	Joist W x H (mm)	MOQ Qty (pcs)	Qty Break (pcs)
<b>BOX</b>				
<b>Galvanised Steel - 1.0mm</b>				
125TH	125 x 300 x 50	125 x 100 to 225	10	50
150TH	150 x 300 x 50	150 x 100 to 225	10	50
<b>A2 - 304 Stainless Steel - 1.0mm</b>				
47THS	47 x 277 x 50	47 x 100 to 225	20	100
76THS	76 x 300 x 50	76 x 100 to 225	20	100
100THS	100 x 300 x 50	100 x 100 to 225	10	50

BMW05

Technical Data	
Width (mm)	All
Length (mm)	All
Bearing (mm)	50
Characteristic value (kN) Eurocode 5	28.04
No. of nail holes	46
Safe working load (kN) BS5628 - Short term	14.02
Safe working load (kN) BS5628 - Medium term	13.35
Safe working load (kN) BS5628 - Long term	11.68

Product Code	W x L x B (mm)	Joist W x H (mm)	MOQ Qty (pcs)	Qty Break (pcs)
<b>BOX</b>				
<b>Galvanised Steel - 1.2mm</b>				
44450LTH	44 x 453 x 50	44 x 150 to 250	10	50
47450LTH	47 x 445 x 50	47 x 150 to 250	10	50
76450LTH	76 x 435 x 50	76 x 175 to 250	10	50
90450LTH	90 x 425 x 50	90 x 150 to 250	10	50
100450LTH	100 x 420 x 50	100 x 150 to 250	10	50
125450LTH	125 x 450 x 50	125 x 175 to 250	10	50
150450LTH	150 x 450 x 50	150 x 175 to 250	10	50

BMW03

### Installation Guidelines

- Ensure the back plate of the hanger sits flat against the timber.
- Joist should be square cut and sit tight to the back of the hanger.
- Fix the joist in every hole with 3.75 x 30 galvanised square twist nails (for stainless steel applications use 2.36 x 30 stainless steel annular ringshank nails).

## Mini Timber Hanger



Timber to timber joist hangers, suitable for light duty applications such as ceiling joists, decking and trimmers.

NOTE: Tag on base of the hanger helps avoid rotation.

Technical Data			
Type	THM	THMS	THMP
Material	Galv	SS	Galv
Width (mm)	All	All	All
Characteristic value (kN) Eurocode 5	8.34	9.5	9.5
Safe working load (kN) BS5628 - Short term	4.17	4.75	4.75
Safe working load (kN) BS5628 - Medium term	3.97	4.53	4.53
Safe working load (kN) BS5628 - Long term	3.47	3.96	3.96

### Installation Guidelines

- Ensure the back plate of the hanger sits flat against the timber.
- Joist should be square cut & sit tight to the back of the hanger.
- Fix the joist in every hole with 3.75 x 30 galvanised square twist nails (for stainless steel applications use 2.36 x 30 stainless steel annular ringshank nails).

Product Code	W x H x B (mm)	Joist W x H (mm)	No. of Nail Holes	MOQ Qty (pcs)	Qty Break (pcs)
<b>BOX</b>					
<b>Galvanised Steel - 1.0mm</b>					
38THM	38 x 75 x 50	38 x 75 to 100	14	20	100
44THM	44 x 68 x 50	44 x 75 to 100	14	20	100
47THM	47 x 67 x 50	47 x 75 to 100	14	20	100
<b>Larger Joist Size</b>					
38THMP	38 x 100 x 50	38 x 100 to 150	20	20	100
44THMP	44 x 97 x 50	44 x 100 to 150	20	20	100
47THMP	47 x 96 x 50	47 x 100 to 150	20	20	100
<b>A2 - 304 Stainless Steel - 1.0mm</b>					
44THMS	44 x 97 x 50	44 x 75 to 100	20	10	50
47THMS	47 x 96 x 50	47 x 75 to 100	20	10	50

BMW03

# Restraints & Wall Starters



## Heavy Duty Restraint Straps



Generally used for horizontal restraint such as roof trusses, rafters and joists tied to masonry. Designed to BS 5268 Part 3 and other building standards for lateral restraint. Manufactured from galvanised steel, for ultimate corrosion resistance use stainless steel.



## Light Duty Restraint Straps



Generally used for vertical restraint such as holding down a wall plate. Manufactured from galvanised steel, for ultimate corrosion resistance use stainless steel.



## Engineered Heavy Duty Restraint Strap

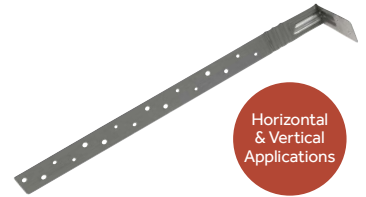

Lightweight design makes it easy to handle, yet retains its structural strength so it can be used instead of traditional heavy duty straps in both horizontal and vertical applications.

Product Code	Length (mm)	Bend (mm)	Total Length (mm)	MOQ Qty (pcs)	Qty Break (pcs)
<b>BUNDLE</b>					
<b>Galvanised Steel - 1.4mm</b>					
600ERSH	500	100	600	10	50
800ERSH	700	100	800	10	50
1000ERSH	900	100	1000	10	50
1200ERSH	1100	100	1200	10	50
1600ERSH	1500	100	1600	10	50

BMW07

### Bent Strap

Product Code	Length (mm)	Bend (mm)	Total Length (mm)	MOQ Qty (pcs)	Qty Break (pcs)
<b>BUNDLE</b>					
<b>Galvanised Steel - 4.0mm</b>					
400BRSH	300	100	400	10	50
600BRSH	500	100	600	10	50
800BRSH	700	100	800	10	50
1000BRSH	900	100	1000	10	50
1200BRSH	1100	100	1200	10	50
1500BRSH	1400	100	1500	10	50
1600BRSH100	1500	100	1600	10	50
1600BRSH	1450	150	1600	10	50
<b>Stainless Steel - 4.0mm</b>					
1000BRSHS	900	100	1000	10	50
1200BRSHS	1100	100	1200	10	50

BMW06

### Bent Strap

Product Code	Length (mm)	Bend (mm)	Total Length (mm)	MOQ Qty (pcs)	Qty Break (pcs)
<b>BUNDLE</b>					
<b>Galvanised Steel - 2.4mm</b>					
300BRSL	200	100	300	10	50
600BRSL	500	100	600	10	50
800BRSL	700	100	800	10	50
1000BRSL	900	100	1000	10	50
1200BRSL	1100	100	1200	10	50
1500BRSL	1400	100	1500	10	50
<b>Stainless Steel - 2.4mm</b>					
1000BRSLs	900	100	1000	10	50

BMW08

### Flat Strap

Product Code	Total Length (mm)	MOQ Qty (pcs)	Qty Break (pcs)
<b>BUNDLE</b>			
<b>Galvanised Steel - 4.0mm</b>			
1000FRSH	1000	10	50

BMW06

### Flat Strap

Product Code	Total Length (mm)	MOQ Qty (pcs)	Qty Break (pcs)
<b>BUNDLE</b>			
<b>Galvanised Steel - 2.4mm</b>			
1000FRSL	1000	10	50
<b>Stainless Steel - 2.4mm</b>			
1000FRSLs	1000	10	50

BMW08

### Twisted Strap

Product Code	Length (mm)	Twist (mm)	Total Length (mm)	MOQ Qty (pcs)	Qty Break (pcs)
<b>BUNDLE</b>					
<b>Galvanised Steel - 4.0mm</b>					
600TRSH	500	100	600	10	50
1000TRSH	900	100	1000	10	50

BMW06

### Twisted Strap

Product Code	Length (mm)	Twist (mm)	Total Length (mm)	MOQ Qty (pcs)	Qty Break (pcs)
<b>BUNDLE</b>					
<b>Galvanised Steel - 2.4mm</b>					
1000TRSL	900	100	1000	10	50

BMW08

### Installation Guidelines

For horizontal restraint

- Use a minimum of six 3.75 x 30mm square twist nails or equivalent fixed to timber joists/rafters.

## Wall Starter Kit

A stainless steel system, designed to join new walls to existing masonry, suitable for both internal and external brick or block walls.

Kit includes: x2 Wall rails, x5 Plugs, coach screws, washers, x10 Wall rail connectors.



### Technical Data

Length (mm)	1170
Design Shear Strength per 2.4m (kN)*	5.1

\*Fixing into existing AAC block work with a compressive strength of 3.5N/mm2

Product Code	Width (mm)	Length (mm)	Kit Length (2 x Profiles) (mm)	MOQ Qty (pcs)	Qty Break (pcs)
<b>BOX</b>					
<b>Stainless Steel</b>					
269666	41	1170	2340	12	40

BMW14

### Installation Guidelines

#### For horizontal restraint

- Use a minimum of seven 3.75 x 30mm square twist nails or equivalent fixed to timber joists/rafters.

#### For vertical restraint

- Use a minimum of ten 3.75 x 30mm square twist nails or equivalent fixed to timber joists/rafters.
- When used as a vertical restraint to hold down a wallplate. Use a minimum length of 900mm



## Structural Fixings



### Truss Clip



For fixing trusses, girders and rafters to wall plate. Can also be used for general applications as a multi-purpose connector to provide restraint whenever two timber members cross.

#### Technical Data

Width (mm)	38	47
Characteristic value (kN) Eurocode 6	6.36	
Safe working load (kN) BS5628 - Short term	3.18	

Product Code	Width (mm)	Total Height (mm)	No. of Nail Holes	MOQ Qty (pcs)	Qty Break (pcs)
<b>BOX</b>					
<b>Galvanised Steel - 1.0mm</b>					
38TC	38	110	12	25	125
47TC	47	110	12	25	125

BMW05

### Angle Bracket



A versatile and general purpose 90° bracket used to strengthen timber joints. Available in galvanised steel. For ultimate corrosion resistance use stainless steel.

#### Technical Data

L x H (mm)	50x50	60x40	90x90	150x90	150x150
Nail Holes (3.75mm)	11	13	15	19	23
Nail Holes (6.0mm)	9	7	-	-	-
Bolt Holes (M8)	-	-	4	5	6
Bolt Holes (M10)	-	-	3	3	3
Bolt Slots (M10)	2	2	2	3	4

Product Code	Length x Height (mm)	Width (mm)	MOQ Qty (pcs)	Qty Break (pcs)
<b>BAG</b>				
<b>Galvanised Steel - 2.0mm</b>				
5050AB*	50 x 50	62	25	100
6040AB*	60 x 40	62	25	100
9090AB	90 x 90	62	25	100
15090AB	150 x 90	62	15	60
150150AB	150 x 150	62	15	45
<b>A2 Stainless Steel - 2.0mm</b>				
6040ABS*	60 x 40	62	25	100
9090ABS	90 x 90	62	25	100

\*Not Reinforced / BMW09

### Flat Connector Plates



Versatile flat brackets for timber jointing and general repair work.

#### Technical Data

Length (mm)	100	180	240	300
Nail Holes (3.75mm)	11	15	19	23
Screw Holes (6.0mm)	9	-	-	-
Bolt Holes (M8)	-	4	5	6
Bolt Holes (M10)	-	3	3	3
Bolt Slots (M10)	2	2	3	4

Product Code	Length (mm)	Width (mm)	Pack Qty (pcs)	Qty Break (packs)
<b>BAG</b>				
<b>Galvanised Steel - 2.0mm</b>				
FCP100	100	62	5	10
FCP180	180	62	5	10
FCP240	240	62	5	10
FCP300	300	62	5	10

BMW09

### Herringbone Joist Strut



Prevent sideways movement or the buckling of joints. Simple alternative to timber noggins.

Product Code	Joist Centre (mm)	Strut Length (mm)	Pack Qty (pcs)	Qty Break (packs)
<b>BUNDLE</b>				
<b>Galvanised Steel - 1.0mm</b>				
HJS400	400	480	10	10
HJS450	450	523	10	10
HJS600	600	680	10	10

BMW04

### Nail Plate



A versatile perforated plate used for connecting or repairing timber. Strengthening ribs for added rigidity. All holes are pressed countersunk to aid location of the nail and to give a flush finish.



EN14545

Product Code	Width (mm)	Length (mm)	MOQ Qty (pcs)	Qty Break (pcs)
<b>BOX</b>				
<b>Galvanised Steel - 1.0mm</b>				
42NP	42	178	20	100
85NP	85	178	20	100
104NP	104	154	20	100
169NP	169	178	10	60
178NP	178	338	10	50
<b>A2 Stainless Steel - 1.0mm</b>				
85NPS	85	178	20	100

BMW09

### Universal Framing Anchor



For strong nailed joints and economical secondary connections in timber framing. Framing Anchors are an effective, versatile and economical method of providing strong, mechanical joints.

Product Code	Width (mm)	Height (mm)	MOQ Qty (pcs)	Qty Break (pcs)
<b>BOX</b>				
<b>Galvanised Steel - 1.0mm</b>				
UFA	40 x 40	124	25	500

BMW03

### Timber Connector



Designed to increase the joint strength when bolting two pieces of timber together.



EN14545

Product Code	Outer Ø (mm)	Hole Ø (mm)	Bore (mm)	Pack Qty (pcs)	Qty Break (packs)
<b>Galvanised Steel</b>					
<b>BOX</b>					
TCD50	50	14.0	M12	100	2
CAB05					
<b>BAG</b>					
TCD50B	50	14.0	M12	15	5
BAG33					
<b>PACK</b>					
TCD50P	50	14.0	M12	6	10
PAK51					

### Helical Bar



Frequently used in masonry joints for crack stitching and reinforcing. Stainless steel for ultimate corrosion resistance.



EN845-1

Product Code	Ø (mm)	Length (mm)	Pack Qty (pcs)	Qty Break (packs)
<b>BUNDLE</b>				
<b>Stainless Steel</b>				
M6HB	6.0	1000	25	10
M8HB	8.0	1000	25	10
BMW12				

### Chemical Resin

For helical grout for stitching & repairs.

See page 97

### Brick Reinforcement Coil

Produced for brick and block work reinforcement. It's primary usage is to prevent cracking. For ultimate corrosion resistance use stainless steel.



Product Code	Width (mm)	Length (m)	Pack Qty (pcs)	Qty Break (packs)
<b>COIL</b>				
<b>Galvanised Steel</b>				
63BRCG	65	20	1	20
100BRCG	100	20	1	20
175BRCG	175	20	1	20
<b>Stainless Steel</b>				
63BRCSS	65	20	1	20
100BRCSS	100	20	1	20
175BRCSS	175	20	1	20
225BRCSS	225	20	1	20
BMW12				

### Waterbar



A steel bar for fitting into door sills for weather protection.

Traditionally used with wooden doors, the water bar is fitted into the threshold so that the front door closes against it, sealing any gaps and preventing wind and rain from entering the property.

Product Code	Length (m)	Width (mm)	MOQ Qty (pcs)	Qty Break (pcs)
<b>BUNDLE</b>				
<b>Galvanised Steel - 4.0mm</b>				
TWB1	1	28	10	50
TWB2	2	28	10	50
BMW11				

### Helical Flat Roof Fixing



Hammer driven fixing frequently used for securing structural 6mm plywood composite insulation board to flat roofing systems.

Made from high tensile steel, the fixing twists into timber without the need for pre-drilling.

Product Code	Size (mm)	MFT (mm)	Pack Qty (pcs)	Qty Break (packs)
<b>BAG</b>				
<b>Zinc</b>				
269745	8.0 x 90	55	25	60
269991	8.0 x 135	100	25	48
269425	8.0 x 165	130	25	48
269637	8.0 x 195	160	25	42
269244	8.0 x 220	185	25	36
269763	8.0 x 250	215	25	32
269278	8.0 x 270	235	25	30
MFT= Max. Fixture Thickness / BMW16				

### Hip Iron

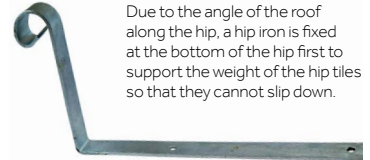

Provides a decorative restraint when bedding hip tiles.

Due to the angle of the roof along the hip, a hip iron is fixed at the bottom of the hip first to support the weight of the hip tiles so that they cannot slip down.

Product Code	Length (mm)	MOQ Qty (pcs)	Qty Break (pcs)
<b>BOX</b>			
<b>Hot Dipped Galvanised - 3.0mm</b>			
HI3003	300	10	50
BMW15			

### Fixing Band



A versatile perforated metal strip which can easily be cut or bent to provide a quick and reliable light weight brace suitable for suspending pipework, cables and doing general repairs.

Product Code	Width (mm)	Length (m)	Pack Qty (pcs)	Qty Break (packs)
<b>CASE* / BAG</b>				
<b>Galvanised Steel</b>				
1210FB*	12	10	1	10
1810FB*	18	10	1	10
2510FB*	25	10	1	10
<b>Stainless Steel</b>				
2010FBS	20	10	1	10
BMW13				

### Coloured Fixing Band

Manufactured from galvanised steel to give a high level of corrosion resistance. Colour coated to match the application.



Product Code	Width (mm)	Length (m)	Pack Qty (pcs)	Qty Break (packs)
<b>CASE</b>				
<b>White</b>				
1210FBWHITE	12	10	1	10
<b>Black</b>				
1210FBBLACK	12	10	1	10
BMW13				

### Drywall Bracket

Designed especially for connecting plasterboard dry lining systems to masonry walls, concrete soffit and timber joists.



Product Code	Total Length (mm)	Pack Qty (pcs)	Qty Break (packs)
<b>BOX</b>			
<b>Zinc</b>			
DB195	195	100	6
DB295	295	100	4
DLB01			

## Cramps & Ties



### Safety Frame Cramp

Traditionally used for securing timber windows and door frames into masonry. They can also be used for restraining masonry to new and existing structures in non structural applications. Two 6mm holes and one 9mm hole.



Product Code	Width (mm)	Projection (mm)	Upstand (mm)	Pack Qty (pcs)	Qty Break (packs)
<b>BOX</b>					
<b>Stainless Steel - 2.0mm</b>					
100SFCS	19	100	50	250	10
150SFCS	19	150	50	250	10
200SFCS	19	200	50	250	10

BMW10

### Heavy Duty Fishtailed Cramp

Two 6mm holes and one 8mm hole. Manufactured from galvanised steel for superior corrosion resistance.



Product Code	Width (mm)	Projection (mm)	Upstand (mm)	MOQ Qty (pcs)	Qty Break (pcs)
<b>BAG</b>					
<b>Galvanised Steel - 2.3mm</b>					
100FFC	25	100	50	25	100
150FFC	25	150	50	25	100
200FFC	25	200	50	25	100

BMW10

### Window Board Tie

A simple solution to tie window boards to masonry.



Product Code	Width (mm)	Projection (mm)	Upstand (mm)	Pack Qty (pcs)	MOQ Qty (pcs)	Qty Break (packs)
<b>BOX</b>						
<b>Galvanised Steel - 2.0mm</b>						
WBT10	12	147	25	10	-	50
WBT	12	147	25	1	100	-

BMW10

### Movement Ties

When used with debonding sleeves, provide restraint in one direction and horizontal movement for expansion and contraction found in long spans of brickwork. The tie sits inside the debonding sleeve allowing the tie to move in situ.



Product Code	Width (mm)	Length (mm)	Pack Qty (pcs)
<b>BAG</b>			
<b>Stainless Steel</b>			
TTSSPE150	19	150	250
TTSSPE200	19	200	250

BMW10

### Movement Tie Debonding Sleeves

Designed for use with movement ties to provide restraint in one direction and horizontal movement for expansion and contraction found in long spans of brickwork. The debonding sleeve is located over the tie to allow the tie to move.



Product Code	Width (mm)	Length (mm)	Pack Qty (pcs)
<b>BAG</b>			
TTDS120	20	120	250

BMW10

### Timber Frame Tie

Timber Frame Ties are suitable for tying masonry outer cladding to softwood structural framework of domestic dwellings and industrial/commercial buildings up to 4 storeys and not greater than 15m in height.

- Complies with a DD140 Type 6 tie.
- Meets with the appropriate parts of NHBC standards.
- Supplied with annular rings hank nails.



Product Code	Width (mm)	Projection (mm)	Cavity Width (mm)	Pack Qty (pcs)	Qty Break (packs)
<b>BOX</b>					
<b>Stainless Steel</b>					
269413	19	130	50	250	10
269846	19	155	75	250	10
269719	19	180	100	250	10

BMW10

### Screw-in Frame Tie

Universal frame and wall ties for connecting wooden window and door frames to masonry and masonry to masonry with the use of a nylon plug.



Product Code	Length (mm)	Thread Length (mm)	Thread Dia (mm)	Pack Qty (pcs)	Qty Break (packs)
<b>BOX</b>					
<b>Zinc &amp; Yellow</b>					
150SFT	150	40	6	100	4

BMW10



## Cavity Wall Ties

Perfect for masonry cavity walls in domestic houses and small commercial buildings of up to three storeys and maximum 1.5m in height. Manufactured from A2 Stainless Steel for ultimate corrosion resistance.

### Type 2 - General Duty Wall Ties



Product Code	Length x Gauge (mm)	Cavity Width (mm)	Max. Wall Height (m)	Pack Qty (pcs)	Qty Break (packs)
<b>BUNDLE</b>					
<b>A2 Stainless Steel</b>					
225WT2	225 x 3	76 to 100	15	250	10
250WT2	250 x 3	101 to 125	15	250	10
275WT2	275 x 3	Up to 150	15	250	10

BMW10

### Type 4 - Light Duty Wall Ties



Product Code	Length x Gauge (mm)	Cavity Width (mm)	Max. Wall Height (m)	Pack Qty (pcs)	Qty Break (packs)
<b>BUNDLE</b>					
<b>A2 Stainless Steel</b>					
200WT4	200 x 2.3	50 to 75	10	250	10
225WT4	225 x 2.3	76 to 100	10	250	10
250WT4	250 x 2.7	101 to 125	10	250	10
275WT4	275 x 2.7	up to 150	10	250	10

BMW10



## Insulation Retaining Discs

Used with a cavity wall tie to hold insulation material against the inner wall of the cavity.



Product Code	Diameter (mm)	Colour	Pack Qty (pcs)	Qty Break (packs)
<b>BAG</b>				
LOCIRD65BL	65	Black	250	6
LOCIRD80R	80	Red	250	4

BMW10

## Damp Proofing



## Damp Proof Membrane



Handy Pack

Commonly used to protect a building's concrete slab from moisture rising from the foundations. A damp proof membrane or DPM is a versatile product and can also be used for a wide range of applications such as creating a protective surface before laying laminate or wood floors. BBA certified.

- Membrane made from 100% recycled materials
- EN 13967:2012

Product Code	Size (m)	Thickness (Microns)	Thickness (Gauge)	Pack Qty (pcs)	Qty Break (packs)
<b>ROLL</b>					
887125	4 x 12.5	500	2000	1	10
887025	4 x 25.0	250	1000	1	10
887425	4 x 25.0	300	1200	1	10
TTS01					
<b>HANDY PACK</b>					
887405	4 x 5.0	250	1000	1	10
TTS01					

## Damp Proof Course



Damp proof course or DPC offers a protective barrier and is used within the inner layers of brick or block walls to protect buildings from rising damp.

- 100% recycled materials

Product Code	W (mm)	L (m)	Thickness (Microns)	Thickness (Gauge)	Pack Qty (pcs)	MOQ Qty (packs)
<b>ROLL</b>						
887100	100	30	500	2000	1	9
887112	112	30	500	2000	1	8
887150	150	30	500	2000	1	6
887225	225	30	500	2000	1	4
887300	300	30	500	2000	1	3
887450	450	30	500	2000	1	2
887600	600	30	500	2000	1	2
TTS02						

## Double Sided Damp Proof Membrane Jointing Tape

A high performance double sided butyl tape used for bonding DPMs. Use with High Strength PVC Builders Tape to provide a continuous damp proof seal between two sheets, where joints cannot be avoided.



- High adhesion
- Backing paper for easy application

Product Code	Colour	Length (m)	Width (mm)	Pack Qty (pcs)	Carton Qty (packs)
<b>ROLL</b>					
DSDJT	Black	10	50	1	12
TAP11					

## High Strength PVC Builders Tape

A strong versatile PVC tape used for jointing PVC and polythene sheets and membranes. Frequently used for sealing contamination barriers, polythene dust sheets, silage covers and bales.



- Flame retardant
- Perfect for electrical, patching & jointing applications

Product Code	Colour	Length (m)	Width (mm)	Pack Qty (pcs)	Carton Qty (packs)
<b>ROLL</b>					
HSBT	Black	33	75	1	36
TAP08					

**Full Tape Range**

See Page 186

## Spacers



## Horseshoe Shims

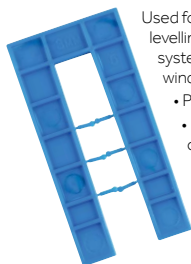

Used for easy and quick levelling of battens, drying/lyning systems, stud work, door and window frames.

- Polypropylene material
- Resistant to weather changes
- Waterproof
- Bag and tub includes two sizes



## Packers



A solution for multiple applications. Used to ensure correct weight distribution of glazed units and increase security around fixing points during frame fitting.

- Polypropylene material
- Resistant to weather changes
- Waterproof
- Strong and durable



## Individual Packs

Product Code	Size (mm)	Thickness (mm)	Colour	Pack Qty (pcs)	Carton Qty (packs)
<b>28MM - BULK BOX - 1,000 PCS</b>					
P1GREENBU	28 x 100	1.0	Green	1,000	10
P2BLACKBU	28 x 100	2.0	Black	1,000	10
P3WHITEBU	28 x 100	3.0	White	1,000	10
P4GREYBU	28 x 100	4.0	Grey	1,000	10
P5BLUEBU	28 x 100	5.0	Blue	1,000	10
P6REDBU	28 x 100	6.0	Red	1,000	10
<b>28MM - BAG - 200 PCS</b>					
P1GREEN	28 x 100	1.0	Green	200	5
P2BLACK	28 x 100	2.0	Black	200	5
P3WHITE	28 x 100	3.0	White	200	5
P4GREY	28 x 100	4.0	Grey	200	5
P5BLUE	28 x 100	5.0	Blue	200	5
P6RED	28 x 100	6.0	Red	200	5

SHL01

## Mixed Packs

Product Code	Size (mm)	T (mm)	Colour	Shim Qty (pcs)	Pack Qty (pcs)	Carton Qty (packs)
<b>MIXED BAG - 100 PCS</b>						
SHIM100	45 x 35	1.0	Yellow	20	100	22
	45 x 35	3.0	Blue	20		
	45 x 35	5.0	Brown	20		
	45 x 35	6.0	Black	10		
	100 x 50	1.0	Yellow	10		
	100 x 50	3.0	Blue	10		
	100 x 50	5.0	Brown	10		
<b>MIXED BAG - 200 PCS</b>						
SHIM	45 x 35	1.0	Yellow	20	200	8
	45 x 35	2.0	Green	20		
	45 x 35	3.0	Blue	20		
	45 x 35	4.0	Red	20		
	45 x 35	5.0	Brown	10		
	45 x 35	6.0	Black	10		
	100 x 50	1.0	Yellow	20		
	100 x 50	2.0	Green	20		
	100 x 50	3.0	Blue	20		
	100 x 50	4.0	Red	20		
	100 x 50	5.0	Brown	10		
	100 x 50	6.0	Black	10		
	<b>MIXED TUB - 400 PCS</b>					
SHIMTUB	45 x 35	1.0	Yellow	40	400	20
	45 x 35	2.0	Green	40		
	45 x 35	3.0	Blue	40		
	45 x 35	4.0	Red	40		
	45 x 35	5.0	Brown	20		
	45 x 35	6.0	Black	20		
	100 x 50	1.0	Yellow	40		
	100 x 50	2.0	Green	40		
	100 x 50	3.0	Blue	40		
	100 x 50	4.0	Red	40		
	100 x 50	5.0	Brown	20		
	100 x 50	6.0	Black	20		

T=Thickness / SHI01

## Mixed Packs

Product Code	Size (mm)	T (mm)	Colour	Packer Qty (pcs)	Pack Qty (pcs)	Qty Break (packs)
<b>24MM - BULK BOX - 1,000 PCS</b>						
744957	24 x 100	1.0	Green	200	1,000	10
	24 x 100	2.0	Black	160		
	24 x 100	3.0	White	200		
	24 x 100	4.0	Grey	120		
	24 x 100	5.0	Blue	200		
	24 x 100	6.0	Red	120		
<b>28MM - BULK BOX - 1,000 PCS</b>						
744224	28 x 100	1.0	Green	200	1,000	10
	28 x 100	2.0	Black	160		
	28 x 100	3.0	White	200		
	28 x 100	4.0	Grey	120		
	28 x 100	5.0	Blue	200		
	28 x 100	6.0	Red	120		

T=Thickness / SHI02

## Mixed Packs

Product Code	Size (mm)	T (mm)	Colour	Packer Qty (pcs)	Pack Qty (pcs)	Qty Break (packs)
<b>28MM - BAG - 200 PCS</b>						
PACKER	28 x 100	1.0	Green	30	200	5
	28 x 100	2.0	Black	40		
	28 x 100	3.0	White	50		
	28 x 100	4.0	Grey	20		
	28 x 100	5.0	Blue	20		
	28 x 100	6.0	Red	40		
<b>28MM - TUB - 400 PCS</b>						
PACKERTUB	28 x 100	1.0	Green	60	400	20
	28 x 100	2.0	Black	80		
	28 x 100	3.0	White	100		
	28 x 100	4.0	Grey	40		
	28 x 100	5.0	Blue	40		
	28 x 100	6.0	Red	80		

T=Thickness / SHI02

## Wedge Strips



Tapered snap-off wedge strips, manufactured from strong and durable plastic.

Allows convenient, multiple 1mm to 8mm levelling thicknesses in one wedge.

Product Code	Size (mm)	Thickness (mm)	Pack Qty (pcs)	Carton Qty (packs)
<b>TIMBAG</b>				
745233	100 x 20	1-8	50	5

BAG34

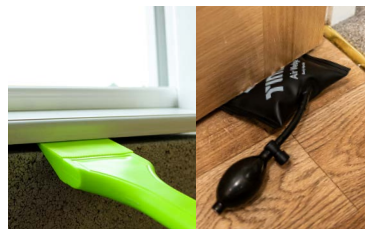

## Glazing Shovel & Air Wedge

See Page 171

## THE NEW (ALMOST) INVISIBLE WALL WEEP FROM TIMLOC

CLEARLY YOU  
CAN (JUST ABOUT)  
SEE WHAT ALL  
THE EXCITEMENT  
IS ABOUT.

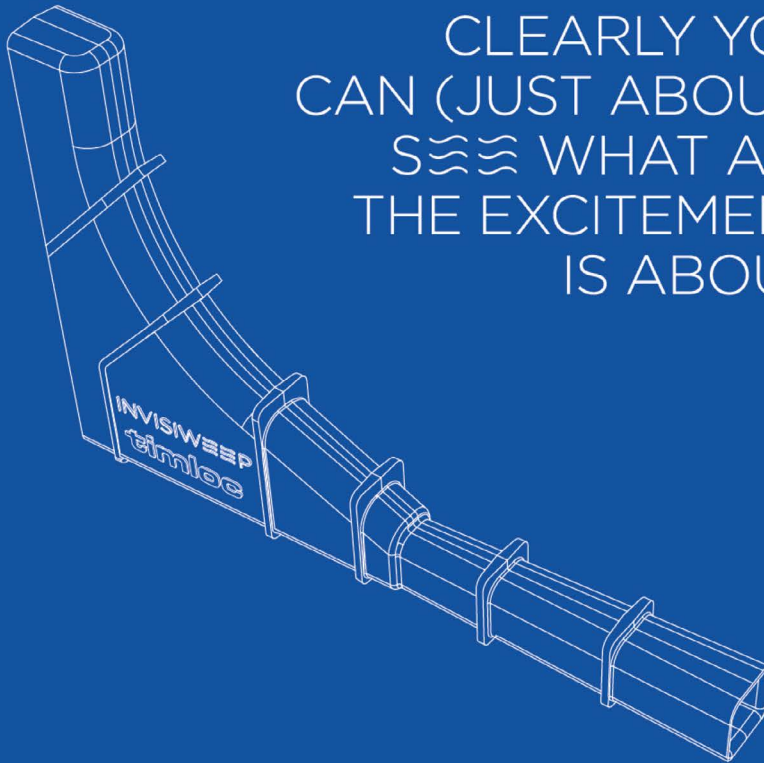

1

### Low profile water outlet

Ensuring minimal visibility when fitted, the water outlet is unobtrusive to the naked eye.

2

### Venturi effect outlet tube

Reduces pressure, allowing for optimal water drainage.

3

### Full height upstand to cavity side

Enables drainage, reducing the risk of blockage if cement builds up in the cavity.

4

### External ribs & tapered profile

To key mortar for a secure fixing.

## Roof-line & Above



## Weeps & Drill Vents

### Push-in Soffit Vent



Circular vents used to allow ventilation from the eaves into roofing.

Product Code	Colour	Size (mm)	Pack Qty (pcs)
<b>BOX</b>			
LOC1139	Grey	70.0	10
LOC1140	White	70.0	10
LOC1141	Black	70.0	10
LOC1142	Brown	70.0	10

RLN01

### Roll Out Dry Fix Ridge Pack



Convenient 'single pack' mechanical fixing solution for roof ridge installations.

Product Code	Size (m)	Pack Qty (pcs)
<b>BOX</b>		
LOC54700	6	1

RLN01



### Invisiweep Wall Weep



Used for discharging water from external walls. Available in a range of colours to suit brickwork.

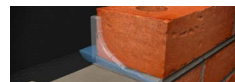

Product Code	Colour	Size H x W x L (mm)	Pack Qty (pcs)
<b>BOX</b>			
LOCIW50BB	Blue/Black	65 x 10 x 102	50
LOCIW50BL	Black	65 x 10 x 102	50
LOCIW50BR	Brown	65 x 10 x 102	50
LOCIW50BU	Buff	65 x 10 x 102	50
LOCIW50CL	Clear	65 x 10 x 102	50
LOCIW50GR	Grey	65 x 10 x 102	50
LOCIW50TE	Terracotta	65 x 10 x 102	50
LOCIW50WH	White	65 x 10 x 102	50

<b>EXTENSION TUBE</b>			
LOCIW500EX	Clear	Ø 6 x 500	10

CNA02

### Ambi-Verge Universal Dry Fix Verge System



Universal dry fix verge system for profiled roof tiles. A robust, attractive and weather resistant alternative to wet mortar bedding.

Product Code	Colour	Size (mm)	Pack Qty (pcs)
<b>BOX</b>			
LOC99141	Grey	405 x 95/160	20
LOC99142	Brown	405 x 95/160	20
LOC99143	Black	405 x 95/160	20
LOC99144	Terracotta	405 x 95/160	20

RLN01

### Ambi-Verge Eaves Starter



Product Code	Colour	Size (mm)	Pack Qty (pcs)
<b>BOX</b>			
LOC99153	Grey	105 x 155	1
LOC99154	Black	105 x 155	1
LOC99155	Brown	105 x 155	1
LOC99156	Terracotta	105 x 155	1

RLN01

### Cavity Wall Weep Vent



Multi-function product for discharging water from external walls and cavity ventilation.

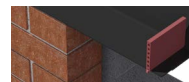

Product Code	Colour	Size H x W x L (mm)	Pack Qty (pcs)
<b>BOX</b>			
LOC1143BB	Blue/Black	65 x 10 x 100	50
LOC1143BL	Black	65 x 10 x 100	50
LOC1143BR	Brown	65 x 10 x 100	50
LOC1143BU	Buff	65 x 10 x 100	50
LOC1143CL	Clear	65 x 10 x 100	50
LOC1143GR	Grey	65 x 10 x 100	50
LOC1143TE	Terracotta	65 x 10 x 100	50
LOC1143WH	White	65 x 10 x 100	50

<b>VENT Extension</b>			
LOC1144	Clear	50mm	100

CNA02

### Universal Verge Ridge/Apex End Cap

Ridge end caps, available in round or angled design.

#### Round End Cap

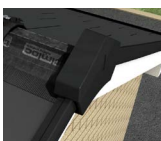

Product Code	Colour	Size (mm)	Pack Qty (pcs)
<b>BOX</b>			
LOC99136	Black	265 x 240	1
LOC99112	Brown	265 x 240	1
LOC99114	Terracotta	265 x 240	1
LOC99113	Grey	265 x 240	1

RLN01

#### Angled End Cap

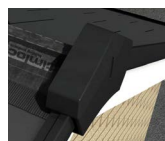

Product Code	Colour	Size (mm)	Pack Qty (pcs)
<b>BOX</b>			
LOC99107	Black	265 x 240	1
LOC99108	Brown	265 x 240	1
LOC99110	Terracotta	265 x 240	1
LOC99109	Grey	265 x 240	1

RLN01

### Drill Vent



Cavity ventilator and drainage weeps. Often fitted retrospectively to improve existing ventilation.

Product Code	Colour	Size (mm)	Drill Hole Ø (mm)	Pack Qty (pcs)
<b>BOX</b>				
LOCVD1	Natural	80	25	50
LOCVD2	Buff	80	25	50
LOCVD3	Terracotta	80	25	50

CNA02



# Underfloor Ventilation



## Telescopic Underfloor Ventilator & Extension Accessories

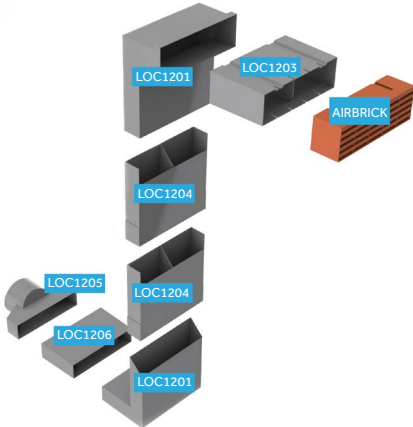

To provide ventilation below suspended ground floors. Telescopic and adjustable to suit numerous brick courses.

Product Code	Size	Pack Qty (pcs)	Carton Qty (packs)
<b>BOX</b>			
<b>Telescopic Underfloor Vent</b>			
LOC1201	up to 5 course	20	-
LOC1201XL	5 to 7 course	10	-
<b>Horizontal Front Extension</b>			
LOC1203	+115mm	20	-
<b>Vertical Extension</b>			
LOC1204	+150mm	20	-
<b>Horizontal Rear Extension</b>			
LOC1206	+100mm	1	20
<b>Duct Adapter</b>			
LOC1205	to suit 110mm	1	20

CNA01

## Airbrick - Plastic

Used in conjunction with underfloor vent system and cavity sleeves to provide ventilation below suspended ground floors and through external walls.



Product Code	Colour	Size W x H x D (mm)	Pack Qty (pcs)
<b>BOX</b>			
LOC1201ABBB	Blue/Black	215 x 69 x 60	20
LOC1201ABBL	Black	215 x 69 x 60	20
LOC1201ABBR	Brown	215 x 69 x 60	20
LOC1201ABBU	Buff	215 x 69 x 60	20
LOC1201ABGR	Grey	215 x 69 x 60	20
LOC1201ABTE	Terracotta	215 x 69 x 60	20
LOC1201ABWH	White	215 x 69 x 60	20

CNA01

# Through-Wall Ventilation



## Aero-Core Anti-Draught Ventilators

Combination ventilator sets for background venting and heat producing appliances.

Aero-Core with Baffle



Aero-Core with Cowl & Baffle



Aero-Core with High Rise



Product Code	Colour	Size (mm)	Pack Qty (pcs)
<b>BOX</b>			
<b>Aero-Core with Baffle</b>			
LOCACV7BR	Brown	127 x 350	1
LOCACV7TE	Terracotta	127 x 350	1
TWW02			
<b>Aero-Core with Cowl &amp; Baffle</b>			
LOCACV7CBR	Brown	127 x 350	1
LOCACV7CTE	Terracotta	127 x 350	1
LOCACV7CWH	White	127 x 350	1
TWW02			
<b>Aero-Core with High Rise</b>			
LOCACV7HRTE	Terracotta	127 x 350	1
TWW02			

## Cavity Sleeves

Tough, flexible ventilators for external walls.

Cavity Sleeve



Telescopic Extension



Baffle



Product Code	Size (inch)	To Suit	Pack Qty (pcs)
<b>BOX</b>			
<b>Cavity Sleeve</b>			
LOC12021	9 x 3	Single airbrick	1
LOC12022	9 x 6	Two airbricks stacked	1
TWW02			
<b>Telescopic Extension</b>			
LOC1237	9 x 3	+90mm	1
LOC1236	9 x 6	+90mm	1
TWW02			
<b>Baffle</b>			
LOC1238	9 x 3	2x per 9 x 6 sleeve	1
TWW02			

## External Cowl

External cowl used to sustain airflow but reduce draughts.



Product Code	Size (mm)	Size (inch)	Pack Qty (pcs)
<b>BOX</b>			
<b>Terracotta</b>			
LOCABC93TE	255 x 95	9 x 3	1
LOCABC96TE	255 x 160	9 x 6	1
LOCABC99TE	255 x 230	9 x 9	1
TWW02			
<b>Brown</b>			
LOCABC93BR	255 x 95	9 x 3	1
LOCABC96BR	255 x 160	9 x 6	1
LOCABC99BR	255 x 230	9 x 9	1
TWW02			

## Insulation Retaining Discs

Used with a cavity wall tie to hold insulation material against the inner wall of the cavity.



See page

**236**



## Internal Grille Vents



### Plastic Grille Vents

Internal white plastic louver vents for sustaining airflow and reducing drafts. Please note: Flyscreen and Hit & Miss vents are not to be used for gas appliance ventilation.

#### Louvre Vent



Product Code	Size (mm)	Size (inch)	Pack Qty (pcs)
<b>BOX</b>			
<b>White</b>			
LOC1218W	165 x 89	6 x 3	1
LOC1207W	242 x 89	9 x 3	1
LOC1211W	242 x 165	9 x 6	1
LOC1212W	242 x 242	9 x 9	1

TWW01

#### Louvre Vent with Flyscreen



Product Code	Size (mm)	Size (inch)	Pack Qty (pcs)
<b>BOX</b>			
<b>White</b>			
LOC1218WF	165 x 89	6 x 3	1
LOC1207WF	242 x 89	9 x 3	1
LOC1211WF	242 x 165	9 x 6	1
LOC1212WF	242 x 242	9 x 9	1

TWW01

#### Hit & Miss Louvre Vent



Product Code	Size (mm)	Size (inch)	Pack Qty (pcs)
<b>BOX</b>			
<b>White</b>			
LOC1219W	165 x 89	6 x 3	1
LOC1208W	242 x 89	9 x 3	1
LOC1209W	242 x 165	9 x 6	1
LOC1210W	242 x 242	9 x 9	1

TWW01

## Access Doors & Panels

### Loft Access Door

Plastic insulated loft access doors provide simple, easy access through a ceiling into the loft space.

#### Drop In



#### Hinged



Product Code	Size (mm)	Pack Qty (pcs)
<b>BOX</b>		
<b>Drop In</b>		
LOC1168	562 x 665	1
		TAC02
<b>Hinged</b>		
LOC1169	562 x 662	1
		TAC02

### Access Panel

Used in both residential and commercial projects. Access panels (also referred to as access hatches) are vital in order to access concealed electrical, plumbing and building services.



Product Code	Size (mm)	Pack Qty (pcs)
<b>BOX</b>		
<b>Clip Fit</b>		
LOCAP110	115 x 165	1
LOCAP200	205 x 205	1
<b>Hinged</b>		
LOCAP150	155 x 235	1
LOCAP300	305 x 305	1
LOCAP450	470 x 470	1

TAC01

### Slotted Loft Door Operating Pole



Product Code	Size (mm)	Pack Qty (pcs)
<b>BAG</b>		
LOCZ1170	600	1
		TAC02

# Refuse



## Builders Bulk Bags

Manufactured from durable polypropylene and designed with an open top, a flat base and lifting loops. Ideal for the transport of all building materials including rubble, gravel, sand, aggregate as well as topsoil, logs, garden waste and non-toxic industrial waste.

- Tested and certified to carry 1 tonne
- Woven 30% recycled polypropylene
- Fully recyclable
- Open top & flat base
- Strong woven lifting loops



Product Code	Size (cm)	Safe Working Load (kg)	Pack Qty (bags)
<b>PACK</b>			
BBB1000	900 x 900 x 800	1000	2 PRO12

## Sandbags

When filled with sand, sandbags provide an effective way to prevent or reduce the risk of flood damage. Also used for temporary weighing down of road signs, gazebos and tarpaulins.

### PP Sandbag



- String at top for convenient tying off
- Ideal for temporary wall building to prevent flood damage
- Reusable



### Hessian Sandbag

- Biodegradable



Product Code	Type	Colour	Size (cm)	Pack Qty (bags)
<b>PACK</b>				
775666	Polypropylene (PP)	White	33.5 x 80	50
775174	Hessian	Natural	34 x 75	50 PRO16

## Heavy Duty Rubble Sacks



Manufactured from strong and durable tear resistant 11 x 10 woven polypropylene, these reusable sacks are available in two sizes and have draw string tops for tying off. Ideal for use on site for building and landscaping waste.



Product Code	Size (cm)	Weight (gsm)	Weight (g)	Pack Qty (bags)	Carton Qty (packs)
<b>PACK</b>					
SRSRD6090	60 x 90	60	70/pce	10	35
SRSRD80120	80 x 120	60	132/pce	10	15 -PRO12

## Rubble Sacks

Convenient and compact rolls of 30 sacks, manufactured from recycled polyethylene. Ideal for general waste on building sites and landscaping work.



Product Code	Size (mm)	Thickness (microns)	Pack Qty (bags)	MOQ Qty (packs)	Pallet Qty (packs)
<b>ROLL</b>					
SRS30	535 x 820	85	30	10	240 PRO12



Merlin Accessories Ltd  
Unit G, Nickel Close  
Winnall Trading Estate  
Winchester  
SO23 7RJ

01962 842002

Opening Hours  
Monday to Thursday: 7:30 - 17:30  
Friday: 7:30 - 17:00